

WHITE ON GREEN INFORMATIONAL SIGN
TO BE ADDED WHEN APPLICABLE

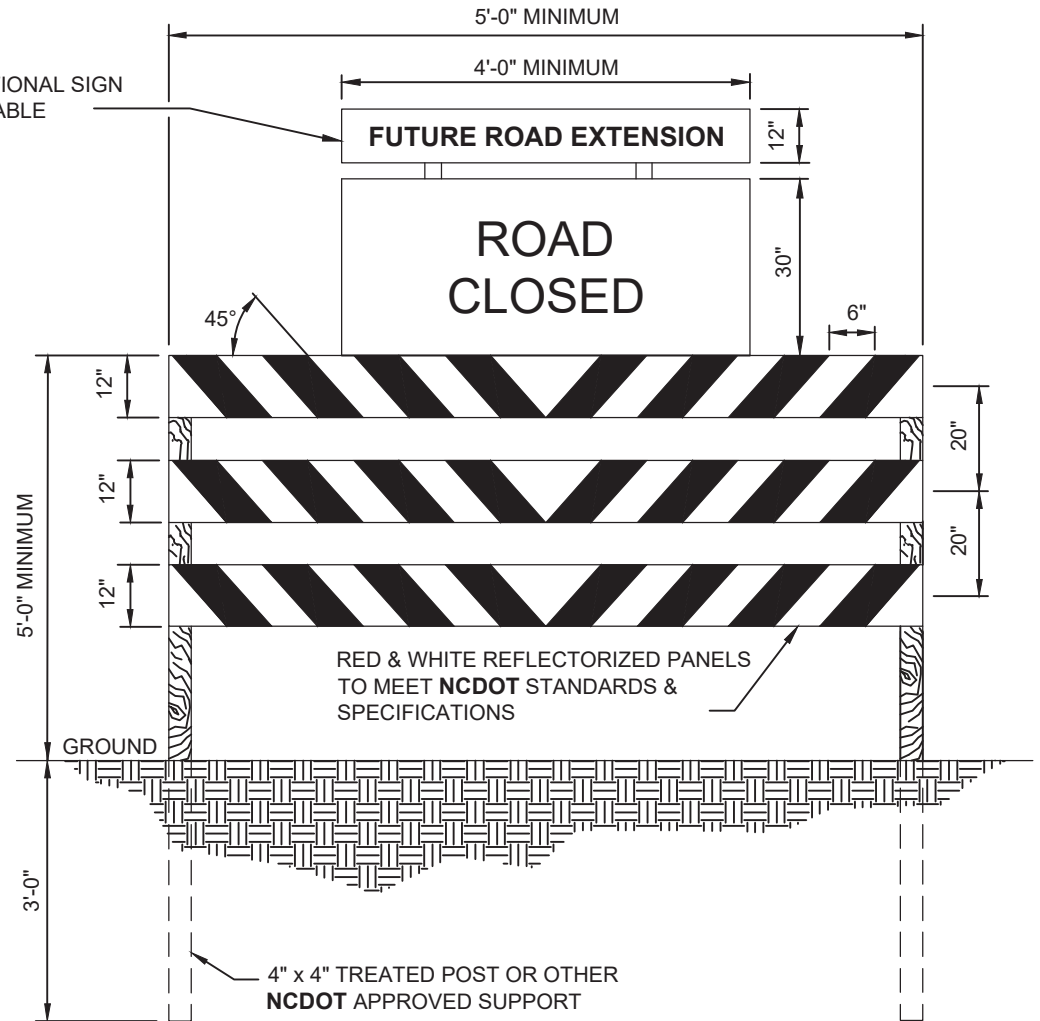

NOTES:

1. BARRICADE(S) TO BE ERECTED ACROSS ENTIRE ROADWAY INCLUDING CURB & GUTTER.
2. ADVANCE WARNING SIGN W14-1 (DEAD END) SHALL BE PLACED JUST AFTER LAST INTERSECTING STREET.
3. MARKINGS FOR BARRICADE RAILS SHALL BE REFLECTIVE AND ALTERNATE RED & WHITE STRIPS.
4. "ROAD CLOSED" SIGN SHALL MEET SPECIFICATIONS OF M.U.T.C.D. R11-2 AND BE REQUIRED ATOP EACH BARRICADE USED.



EFFECTIVE: 12/13/21

STANDARD TEMPORARY BARRICADE FOR DEAD END ROADS

TOWN OF PITTSBORO

STANDARD CONSTRUCTION
DETAIL

STANDARD NO: ST-08-013