

- NOTES:**
1. PUMP STATION PROPERTY OR EASEMENT SHALL BE 50' x 50' (ft.) MINIMUM.
 2. EQUIPMENT LOCATIONS AND DIMENSIONS MAY VARY.
 3. SITE WITHIN FENCE SHALL BE 5 INCH THICK REINFORCED CONCRETE SLAB OR 3 INCHES CRUSHED STONE OVER GEOTEXTILE FABRIC (SPECIFIED BY DIRECTOR).
 4. THE ELECTRIC POWER UNIT LOCATION SHALL BE MINIMUM 5' CLEARANCE FROM FENCE/WALL AND MINIMUM 10' IN FRONT.
 5. BYPASS CONNECTION LOCATION WILL VARY.

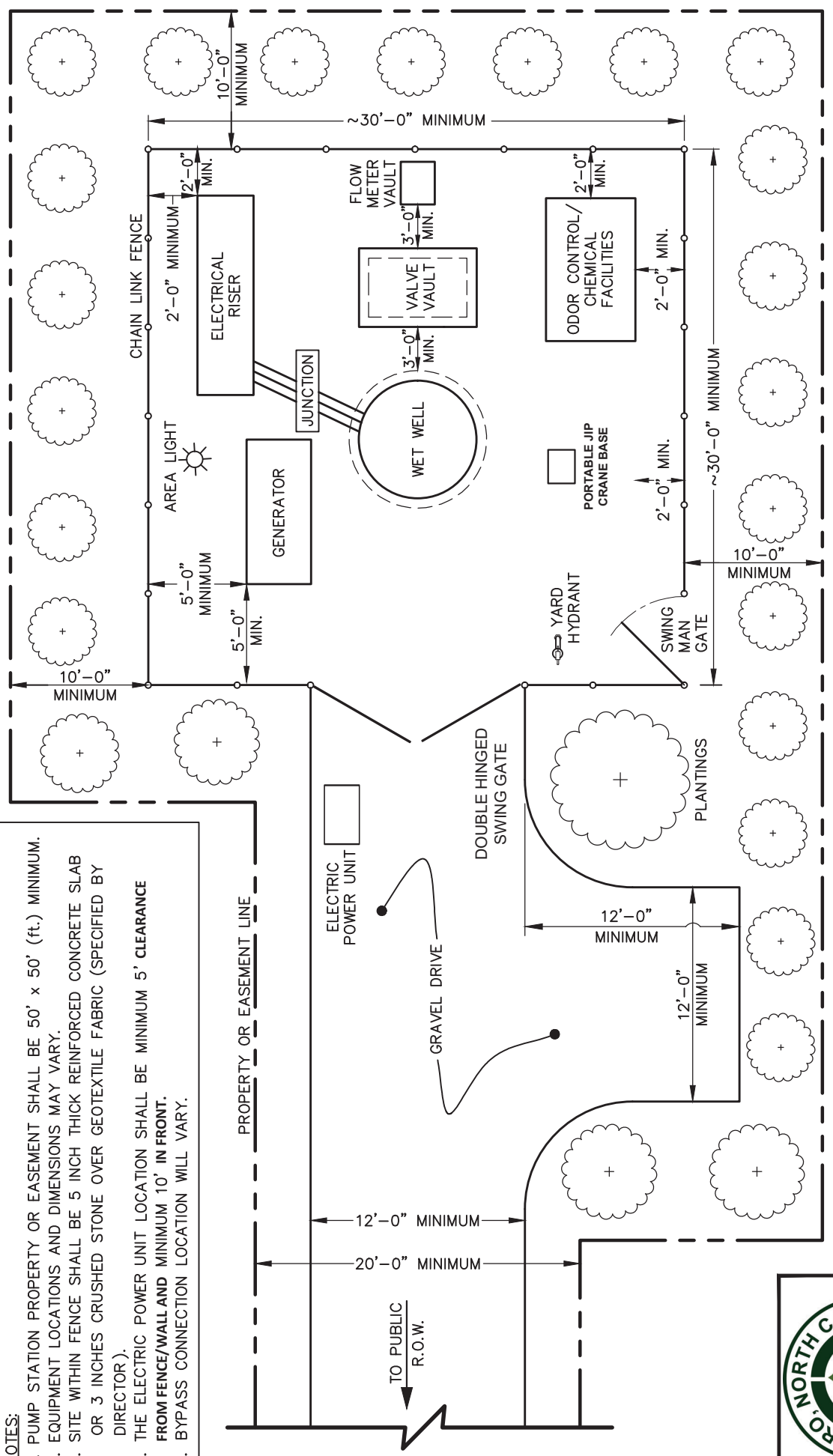

TOWN OF PITTSBORO
STANDARD CONSTRUCTION
DETAIL

PUMP STATION SITE LAYOUT

EFFECTIVE: 4/11/22

STANDARD NO: PW-05-001